

# BONBON SHADE

DESIGN BY ANA KRAŠ



Inspired by her drawings, Ana Kraš' Bonbon Lamp Shades are hand-woven using an original technique to create textured, one-of-a-kind pieces that can stand on their own as powerful decorative objects even when the bulb is not switched on. In Ana's lampshade collaboration with HAY, every shade is hand woven with nylon-wool yarn around a powder-coated steel frame, resulting in individual lampshades that vary slightly in their appearance and surface aesthetic. The cord sets for the lamps are sold separately and are available in two designs – a table/floor variant with an in-line rocker switch, and a pendant variant for ceiling lamps. Both variants can be used with the two different lampshade sizes and are not supplied with a bulb.

## PRODUCT DETAILS

- / A family of hand-woven lamp shades that transcends art and design boundaries.
- / High quality fabric, 80% wool, 20% nylon yarn mix.
- / Utilising a standard retro fit LED bulb (E27) for both table and pendant lamps.
- / The cord sets for the lamps are sold separately and are available in two designs – a table/floor variant with an in-line rocker switch, and a pendant variant for ceiling lamps.
- / Both cord sets come without a bulb
- / Suitable for both private and office environments.
- / For indoor use only.

# HAY

**MATERIAL**

LAMP FRAME / Powder coated steel.

LAMP EXTERIOR / Yarn in 80% wool and 20% nylon mix.

CORD SETS / The Cord Sets are sold separately.  
Table cord set features an in-line rocker switch.

Please note that the pendant and table cord sets are in black only.

**SHADE COLOUR**

Available in 5 different colour palettes.

- / Ice Cream
- / City
- / Grey Melange
- / Yellow Melange
- / Earth Tones



ICE CREAM  
CORAL POWDER  
COATED STEEL FRAME



CITY  
PEBBLE GREY POWDER  
COATED STEEL FRAME



GREY MELANGE  
DARK BLUE POWDER  
COATED STEEL FRAME



YELLOW MELANGE  
CREAM WHITE POWDER  
COATED STEEL FRAME

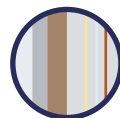

EARTH TONES  
DARK BLUE POWDER  
COATED STEEL FRAME

**FRAME COLOUR**

Available in 4 different colours.

- / Coral powder coated steel (RAL 2002)
- / Pebble grey powder coated steel (RAL 7032)
- / Dark blue powder coated steel (RAL 5003)
- / Cream white powder coated steel (RAL 9010)



CORAL POWDER  
COATED STEEL



PEBBLE GREY POWDER  
COATED STEEL



DARK BLUE POWDER  
COATED STEEL



CREAM WHITE POWDER  
COATED STEEL

**COMBINATIONS**

COLOUR \ SIZE	ICE CREAM / CORAL	CITY / PEBBLE GREY	GREY MELANGE / DARK BLUE	YELLOW MELANGE / CREAM WHITE	EARTH TONES / DARK BLUE
BONBON 320			•	•	
BONBON 380	•	•			
BONBON 500					•

**CONSTRUCTION**

The lamp is hand-woven in an original weaving technique around a spot welded, powder coated steel frame. The entire production is based in Europe.

## DIMENSIONS

### BONBON SHADE 320

WIDTH / 32 cm / 12.6"

DEPTH / 32 cm / 12.6"

HEIGHT / 38 cm / 15"

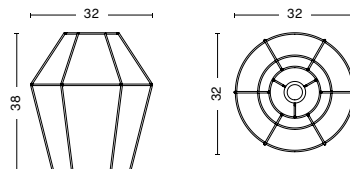

### BONBON SHADE 380

WIDTH / 38 cm / 15"

DEPTH / 38 cm / 15"

HEIGHT / 32 cm / 12.6"

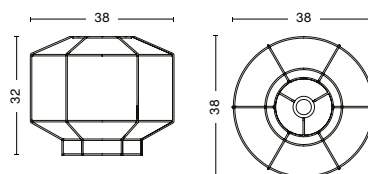

### BONBON SHADE 500

WIDTH / 50 cm / 19.7"

DEPTH / 50 cm / 19.7"

HEIGHT / 46 cm / 18.3"

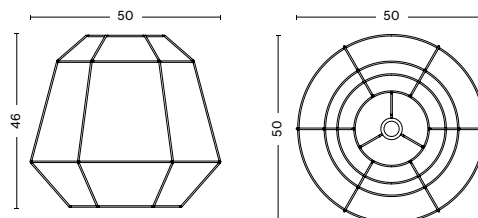

## RECOMMENDED LIGHT SOURCE

Please note the bulb is not included.

HAY recommends using the Bonbon Shades with LED bulbs.

SHADE 320 & 380 / LED E27 (A19), 10-13W, 1000-1500lm, 2700k, warm white

SHADE 500 / LED E27 (A21 or G30), 10-13W, 1000-1500lm, 2700k, warm white

## DOWNLOADS

Packshots and lifestyle photos, 2D / 3D files, care and maintenance instructions, CE attestation of conformity certificates, product fact sheets, and product presentations are available in our Image Bank at hay.com.

[Link to downloads.](#)

## CERTIFICATIONS

/ CE approved: This product has been assessed and complies with the essential requirements of the relevant European directives.



# CORD SET TABLE



## MATERIAL

FITTING / Injection moulded ABS.

CORD / Braided fabric with PVC isolation.

SWITCH / Injection moulded ABS.

## COLOUR

Please note that the colour code is indicative.  
Available in 1 colour.

/ Soft Black (RAL 9004)



SOFT BLACK

## CERTIFICATIONS

/ CE approved: This product has been assessed and complies with the essential requirements of the relevant European directives.



Tested according to the following European EN / IEC standards which relate specifically to electrical lighting products including:

- / EN 60598-2-4:1997 (portable luminaires)
- / EN 60598-1:2015 (general requirements)

## DIMENSIONS

DIAMETER / 4 cm / 3.9"

CORD LENGTH / 240 cm / 80.3"

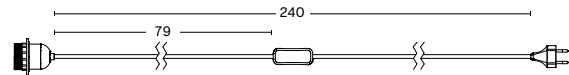

## TECHNICAL SPECIFICATIONS

/ LIGHT SOURCE / LED E27\*

/ DIMMABLE / No

/ POWER SUPPLY / 220-240V AC at 50-60Hz

/ CORD LENGTH / 240 cm

/ SWITCH / Inline switch located 79 cm from the fitting

\*Bulb not included

## DOWNLOADS

Packshots and lifestyle photos, 2D / 3D files, care and maintenance instructions, CE attestation of conformity certificates, product fact sheets, and product presentations are available in our Image Bank at hay.com.

[Link to downloads.](#)

# CORD SET PENDANT



## MATERIAL

CEILING MOUNT / Textured ABS.

CORD / Braided fabric with PVC isolation.

## COLOUR

Please note that the colour code is indicative.  
Available in 1 colour

/ Soft Black (RAL 9004)



SOFT BLACK

## CERTIFICATIONS

/ CE approved: This product has been assessed and complies with the essential requirements of the relevant European directives.



Tested according to the following European EN / IEC standards which relate specifically to electrical lighting products including:

/ EN 60598-2-4:1997 (portable luminaires)

/ EN 60598-1:2015 (general requirements)

## DIMENSIONS

DIAMETER / 10,5 cm / 4.1"

CORD LENGTH / 400 cm / 159.4"

## TECHNICAL SPECIFICATIONS

/ LIGHT SOURCE / LED E27\*

/ POWER (watts) / MAX. 15W

/ DIMMABLE / No

/ POWER SUPPLY / 220-240V AC at 50-60Hz

/ CORD LENGTH / 400 cm

/ SWITCH / No

\*Bulb not included

## DOWNLOADS

Packshots and lifestyle photos, 2D / 3D files, care and maintenance instructions, CE attestation of conformity certificates, product fact sheets, and product presentations are available in our Image Bank at hay.com.

[Link to downloads.](#)

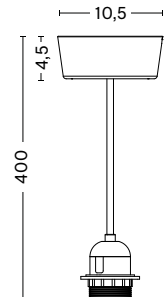

# HAY